

907
S. Perry
St

MOTION NO. 54-93

A MOTION ACCEPTING THE WRITTEN REPORT, FINDINGS OF FACT AND RECOMMENDATION OF THE PLANNING COMMISSION OF THE CITY OF NAPOLEON, OHIO; AND APPROVING THE ISSUANCE OF A SPECIAL-USE PERMIT TO THE HENRY COUNTY AGRICULTURAL SOCIETY TO PERMIT THE ESTABLISHMENT AND OPERATION OF A PARKING LOT AT 1048 SOUTH PERRY STREET IN THE CITY OF NAPOLEON, OHIO, SUBJECT TO CERTAIN CONDITIONS.

WHEREAS, an application by The Henry County Agricultural Society for a special-use permit for the establishment and operation of a parking lot at 1048 South Perry Street in the City of Napoleon, Ohio (hereinafter called "the City") was filed with the City Zoning Administrator pursuant to certain provisions of Chapter 151 of the City's Revised Code of General Ordinances; and

WHEREAS, the City Planning Commission held a public hearing on such application on April 13, 1993 (i.e. Hearing #PC 93/12) and, as a result thereof, made certain written findings of fact and a recommendation to this City Council that such special-use permit be granted, subject to certain conditions.

NOW, THEREFORE, BE IT MOVED AND APPROVED BY THE COUNCIL OF THE CITY OF NAPOLEON, STATE OF OHIO:

Section 1. That the written report, findings of fact and recommendation of the Planning Commission of the City of Napoleon, Ohio (hereinafter called "the City") for the issuance of a special-use permit to The Henry County Agricultural Society to permit the establishment and operation of a parking lot at

1048 South Perry Street in the City, subject to certain conditions, is accepted.

Section 2. That such special-use permit is approved, subject to the following conditions:

(A) That a twenty (20)-foot wide greenbelt and screening of lawn and shrubbery be established and maintained along the northerly boundary line of the applicant's property; and

(B) That a ten (10)-foot wide greenbelt and screening of lawn and shrubbery be established and maintained along the southerly boundary line of the applicant's property; and

(C) That there be a front setback line of two hundred (200) feet in which no parking shall be permitted; and

(D) That there be constructed a concrete drive approach from the pavement of South Perry Street to the applicant's property line, which shall be six (6)-inches thick and thirty-five (35) feet wide at the property line; and

(E) That there be provided a four (4)-foot high fence along the rear yards of all adjoining residentially-used property boundaries during the operation of the Henry County Fair and all other times of intensive usage.

Section 3. That it is found and determined that all formal actions of this City Council concerning and relating to

the adoption of this Motion were adopted in open meetings of this City Council, and that all deliberations of this City Council and any of its committees that resulted in such formal actions were in compliance with all legal requirements, including Section 121.22 of the Ohio Revised Code and the City's Revised Code of General Ordinances.

Section 4. That this Motion shall be in full force and effect immediately after its passage.

Passed: June 7th, 1993

Steven R. Lankenau
Steven R. Lankenau, Mayor

Attest:

Rupert W. Schweinhagen
Rupert W. Schweinhagen, Finance Director

AGRI.MOT

HENRY CO. FAIR GROUNDS

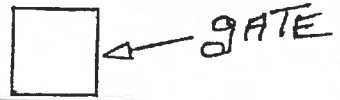

ST. RT. # 108

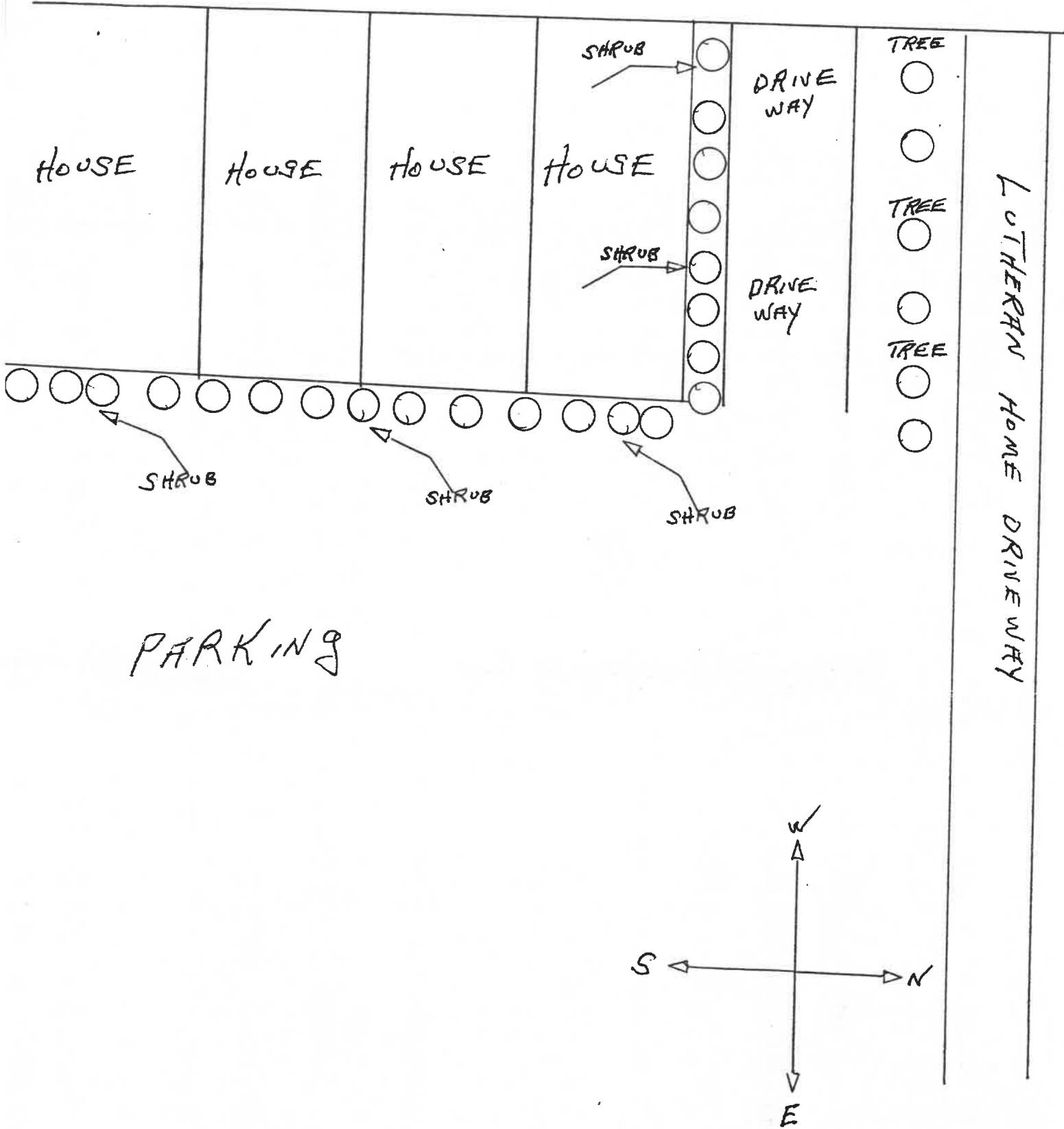

ST. RT. 108

80 FT.

35 FT.
DRIVEWAY

LOTHERAN HOME DRIVEWAY

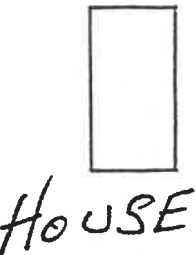

HOUSE

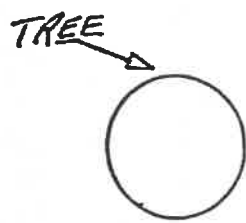
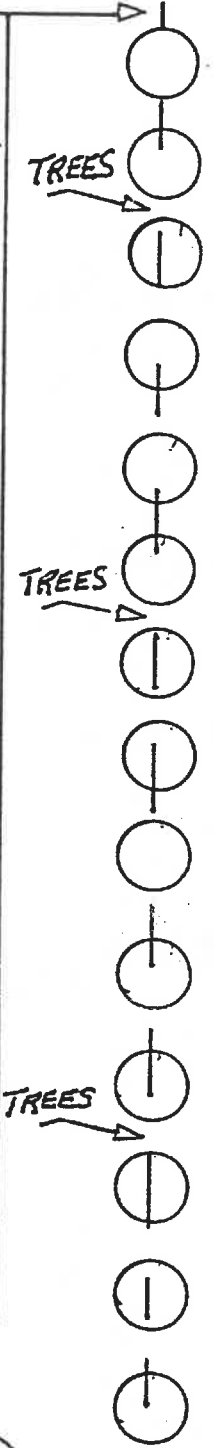
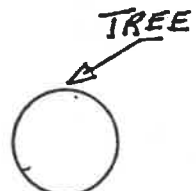
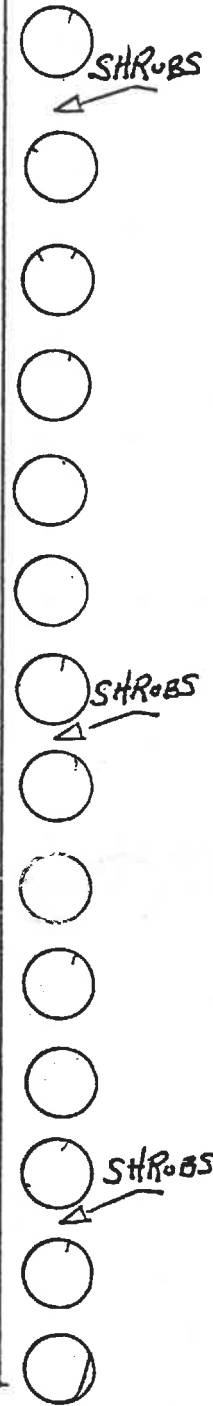

PROPOSAL "A"

RACE TRACK

GROUNDS

Fair Grounds

907

SOUTH

RAYMOND

THIRD

SCHOOL HELLER AND

SIDLINGER

1st. ADDITION

201 ADDITION

FIFTH

STREET

BADEN SUB-DIV

Stone by City ?

Proposed Development

Existing Lutheran Home

MIDDLE RD.

1237

1318.2'

1487.4'

1492.4'

STREET

270'

8058	25
808	25
813	28
821	28
833	28
837	28
839	28

802	82.5	121	82.5	131	82.5
59	82.5	58	82.5	57	82.5
1	82.5	3	82.5	4	82.5
2	82.5	3	82.5	4	82.5
15	82.5	16	82.5	17	82.5
18	82.5	19	82.5	20	82.5
21	82.5	22	82.5	23	82.5
24	82.5	25	82.5	26	82.5
27	82.5	28	82.5	29	82.5
30	82.5	31	82.5	32	82.5
33	82.5	34	82.5	35	82.5
36	82.5	37	82.5	38	82.5
39	82.5	40	82.5	41	82.5
42	82.5	43	82.5	44	82.5
45	82.5	46	82.5	47	82.5
48	82.5	49	82.5	50	82.5
51	82.5	52	82.5	53	82.5
54	82.5	55	82.5	56	82.5
57	82.5	58	82.5	59	82.5
60	82.5	61	82.5	62	82.5
63	82.5	64	82.5	65	82.5
66	82.5	67	82.5	68	82.5
69	82.5	70	82.5	71	82.5
72	82.5	73	82.5	74	82.5
75	82.5	76	82.5	77	82.5
78	82.5	79	82.5	80	82.5
81	82.5	82	82.5	83	82.5
84	82.5	85	82.5	86	82.5
87	82.5	88	82.5	89	82.5
90	82.5	91	82.5	92	82.5
93	82.5	94	82.5	95	82.5
96	82.5	97	82.5	98	82.5
99	82.5	100	82.5	101	82.5
102	82.5	103	82.5	104	82.5
105	82.5	106	82.5	107	82.5
108	82.5	109	82.5	110	82.5
111	82.5	112	82.5	113	82.5
114	82.5	115	82.5	116	82.5
117	82.5	118	82.5	119	82.5
120	82.5	121	82.5	122	82.5
123	82.5	124	82.5	125	82.5
126	82.5	127	82.5	128	82.5
129	82.5	130	82.5	131	82.5
132	82.5	133	82.5	134	82.5
135	82.5	136	82.5	137	82.5
138	82.5	139	82.5	140	82.5
141	82.5	142	82.5	143	82.5
144	82.5	145	82.5	146	82.5
147	82.5	148	82.5	149	82.5
150	82.5	151	82.5	152	82.5
153	82.5	154	82.5	155	82.5
156	82.5	157	82.5	158	82.5
159	82.5	160	82.5	161	82.5
162	82.5	163	82.5	164	82.5
165	82.5	166	82.5	167	82.5
168	82.5	169	82.5	170	82.5
171	82.5	172	82.5	173	82.5
174	82.5	175	82.5	176	82.5
177	82.5	178	82.5	179	82.5
180	82.5	181	82.5	182	82.5
183	82.5	184	82.5	185	82.5
186	82.5	187	82.5	188	82.5
189	82.5	190	82.5	191	82.5
192	82.5	193	82.5	194	82.5
195	82.5	196	82.5	197	82.5
198	82.5	199	82.5	200	82.5
201	82.5	202	82.5	203	82.5
204	82.5	205	82.5	206	82.5
207	82.5	208	82.5	209	82.5
210	82.5	211	82.5	212	82.5
213	82.5	214	82.5	215	82.5
216	82.5	217	82.5	218	82.5
219	82.5	220	82.5	221	82.5
222	82.5	223	82.5	224	82.5
225	82.5	226	82.5	227	82.5
228	82.5	229	82.5	230	82.5
231	82.5	232	82.5	233	82.5
234	82.5	235	82.5	236	82.5
237	82.5	238	82.5	239	82.5
240	82.5	241	82.5	242	82.5
243	82.5	244	82.5	245	82.5
246	82.5	247	82.5	248	82.5
249	82.5	250	82.5	251	82.5
252	82.5	253	82.5	254	82.5
255	82.5	256	82.5	257	82.5
258	82.5	259	82.5	260	82.5
261	82.5	262	82.5	263	82.5
264	82.5	265	82.5	266	82.5
267	82.5	268	82.5	269	82.5
270	82.5	271	82.5	272	82.5
273	82.5	274	82.5	275	82.5
276	82.5	277	82.5	278	82.5
279	82.5	280	82.5	281	82.5
282	82.5	283	82.5	284	82.5
285	82.5	286	82.5	287	82.5
288	82.5	289	82.5	290	82.5
291	82.5	292	82.5	293	82.5
294	82.5	295	82.5	296	82.5
297	82.5	298	82.5	299	82.5
300	82.5	301	82.5	302	82.5
303	82.5	304	82.5	305	82.5
306	82.5	307	82.5	308	82.5
309	82.5	310	82.5	311	82.5
312	82.5	313	82.5	314	82.5
315	82.5	316	82.5	317	82.5
318	82.5	319	82.5	320	82.5
321	82.5	322	82.5	323	82.5
324	82.5	325	82.5	326	82.5
327	82.5	328	82.5	329	82.5
330	82.5	331	82.5	332	82.5
333	82.5	334	82.5	335	82.5
336	82.5	337	82.5	338	82.5
339	82.5	340	82.5	341	82.5
342	82.5	343	82.5	344	82.5
345	82.5	346	82.5	347	82.5
348	82.5	349	82.5	350	82.5
351	82.5	352	82.5	353	82.5
354	82.5	355	82.5	356	82.5
357	82.5	358	82.5	359	82.5
360	82.5	361	82.5	362	82.5
363	82.5	364	82.5	365	82.5
366	82.5	367	82.5	368	82.5
369	82.5	370	82.5	371	82.5
372	82.5	373	82.5	374	82.5
375	82.5	376	82.5	377	82.5
378	82.5	379	82.5	380	82.5
381	82.5	382	82.5	383	82.5
384	82.5	385	82.5	386	82.5
387	82.5	388	82.5	389	82.5
390	82.5	391	82.5	392	82.5
393	82.5	394	82.5	395	82.5
396	82.5	397	82.5	398	82.5
399	82.5	400	82.5	401	82.5
402	82.5	403	82.5	404	82.5
405	82.5	406	82.5	407	82.5
408	82.5	409	82.5	410	82.5
411	82.5	412	82.5	413	82.5
414	82.5	415	82.5	416	82.5
417	82.5	418	82.5	419	82.5
420	82.5	421	82.5	422	82.5
423	82.5	424	82.5	425	82.5
426	82.5	427	82.5	428	82.5
429	82.5	430	82.5	431	82.5
432	82.5	433	82.5	434	82.5
435	82.5	436	82.5	437	82.5
438	82.5	439	82.5	440	82.5
441	82.5	442	82.5	443	82.5
444	82.5	445	82.5	446	82.5
447	82.5	448	82.5	449	82.5
450	82.5	451	82.5	452	82.5
453	82.5	454	82.5	455	82.5
456	82.5	457	82.5	458	82.5
459	82.5	460	82.5	461	82.5
462	82.5	463	82.5	464	82.5
465	82.5	466	82.5	467	82.5
468	82.5	469	82.5	470	82.5
471	82.5	472	82.5	473	82.5
474	82.5	475	82.5	476	82.5
477	82.5	478	82.5	479	82.5
480	82.5	481	82.5	482	82.5
483	82.5	484	82.5	485	82.5
486	82.5	487	82.5	488	82.5
489	82.5	490	82.5	491	82.5
492	82.5	493	82.5	494	82.5
495	82.5	496	82.5	497	82.5
498	82.5	499	82.5	500	82.5

1010	180
018	180
028	180
032	180
044	180
048	180
1052	180
1068	180
1084	180
1098	180
1112	180
1126	180
1140	180
1154	180
1168	180
1182	180
1196	180
1210	180
1224	180
1238	180
1252	180
1266	180
1280	180
1294	180
1308	180
1322	180
1336	180
1350	180
1364	180
1378	180
1392	180
1406	180
1420	180
1434	180
1448	180
1462	180
1476	180
1490	180
1504	180
1518	180
1532	180
1546	180
1560	180
1574	180
1588	180
1602	180
1616	180
1630	180
1644	180
1658	180
1672	180
1686	180
1700	180
1714	180
1728	180
1742	180
1756	180
1770	180
1784	180
1798	180
1812	180
1826	180
1840	180
1854	180
1868	180
1882	180
1896	180
1910	180
1924	180
1938	180
1952	180
1966	180
1980	180
1994	180
2008	180
2022	180
2036	180
2050	180
2064	180
2078	180
2092	180
2106	180
2120	180
2134	180
2148	180
2162	180
2176	180
2190	180
2204	180
2218	180
2232	180
2246	180
2260	180

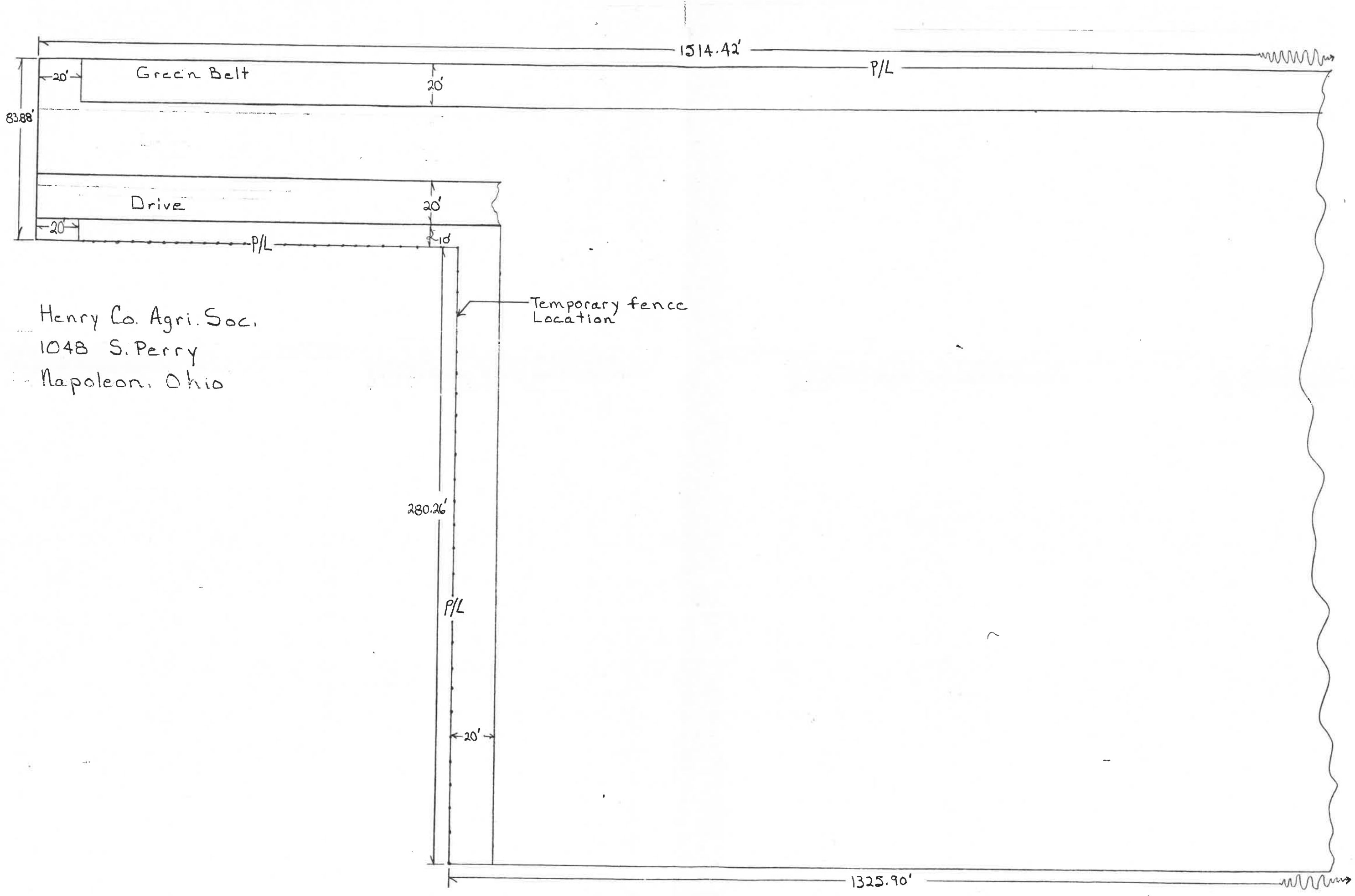

Henry Co. Agri. Soc.
1048 S. Perry
Napoleon, Ohio

Temporary fence
Location

